

2

1

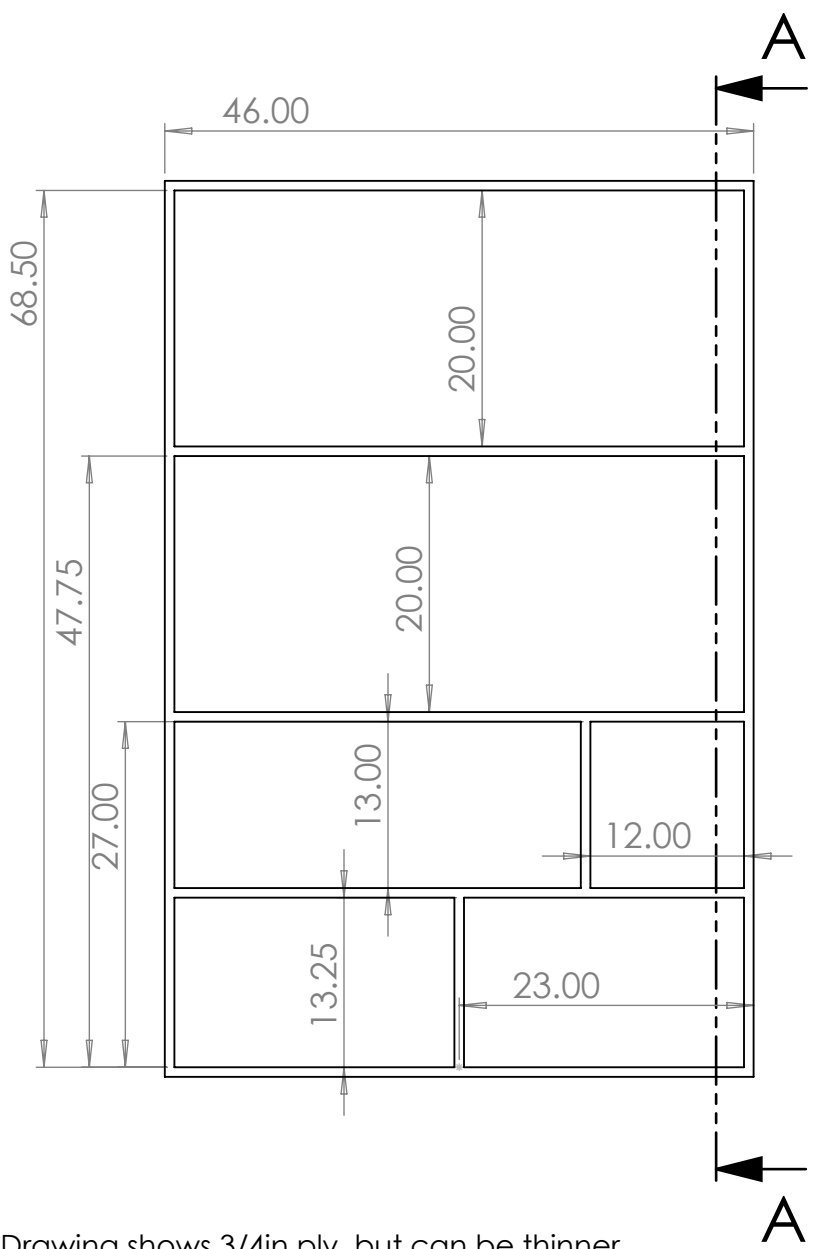

SECTION A-A

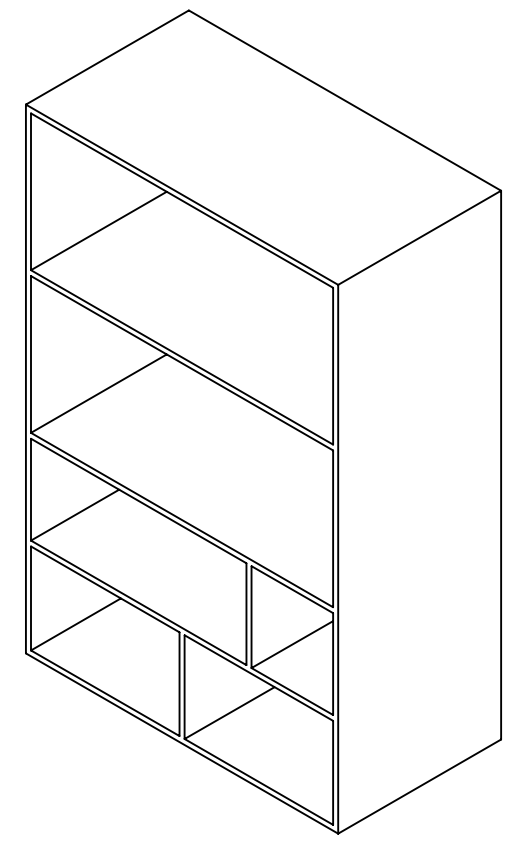
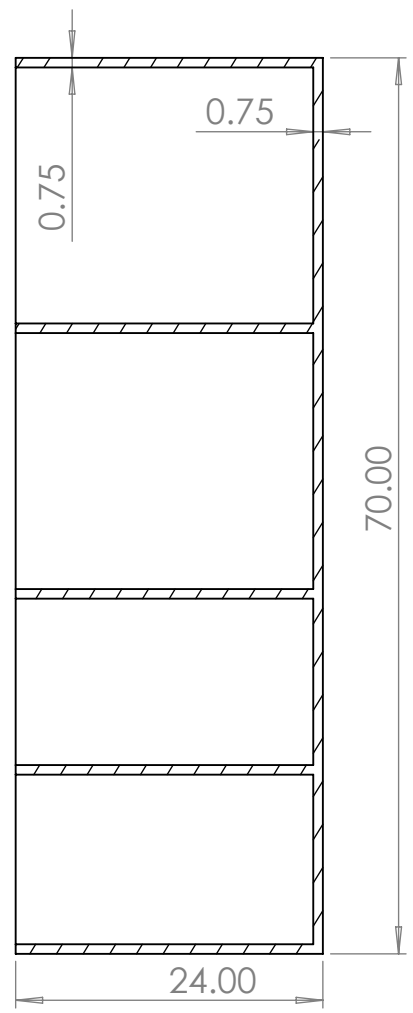

Drawing shows 3/4in ply, but can be thinner or thicker if deemed suitable

If need support for upper shelves, place support in the middle of the shelf so as to split the space in half

COMMENTS:
Butt joints are fine, dimensions should be +/- 1/8in
Shelf stores 3d printers and mid-weight tools

W46 Shop		
TITLE:		
<h1>Storage Shelf</h1>		
SIZE	DWG. DESC	REV
A	Shop Storage	1
AUTHOR: ELIJAH BELL	INCHES	SCALE: 1:15 Modified: 4/14/2023 SHEET 1 OF 1

2

1